



WINDOW NATION

WINDOWS • SIDING • DOORS

WOODSTAR™ Premium Wood Window System

WHY WINDOW NATION?

OVER 350,000 WINDOWS INSTALLED IN MORE THAN 65,000 HOMES

ATTENTION TO DETAIL



- 50 Point Factory Inspection
- 20 Point Installation Review
- 97% Customer Satisfaction on clean up and safety
- Custom windows made to 3mm for precision, accuracy, and a tight seal
- 80,000+ windows installed last year with 99.5% requiring no follow up service

QUALITY



Window Nation uses America's only integrated system of window installation materials, insulation, sealant and caulking:

- OSI Quad Foam
- OSI Quad Max Exterior Sealant
- Ultra-Premium High Performance Exterior Trim Coil
- Concrobium Mold Spray Treatment

EXPERIENCE



- Installation Crew Leaders average more than 20,000 windows & 16 years experience
- Service Technicians with an average of 15 years experience
- Over 350,000 windows installed in over 65,000 homes
- 5th Largest Window Retailer in the U.S.A., ranked by Remodeling Magazine

PRODUCT SELECTION



- Over 1,500 custom window and door style combinations
- Name Brand Windows available in vinyl, wood and fiberglass
- ENERGY STAR® rated products
- Windows engineered for the specific climate we live in

TRUST



- A+ BBB rating
- Angie's List Super Service award winner
- Limited lifetime warranty
- Exclusive 30-Day price protection guarantee
- Licensed, bonded and insured

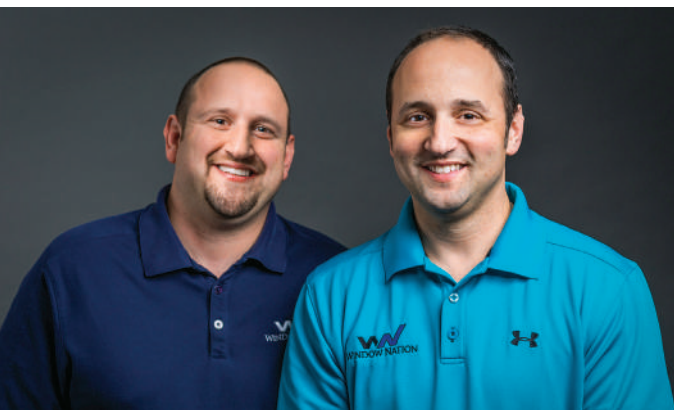

97%
SATISFACTION RATING
SURVEYED BY
GUILD QUALITY

80,000 WINDOWS INSTALLED
LAST YEAR WITH
99.5%
REQUIRING NO FOLLOW-UP SERVICE

Unmatched Installation Experience

Great windows are only great if they're installed properly. It's critical for all components of the installation to work together – insulation, caulking, sealants, and the window itself.

It Starts With Quality Materials

① **QUAD Low-Expansion Foam**

- Single-component, minimal expansion and low-pressure poly-urethane foam specifically designed for replacement window applications
- Ideal foam for sealing gaps, cracks, holes or voids around windows
- Closed-cell structure of this material provides an R-factor of 5 per inch of cured foam, making it an efficient method for stopping air and moisture infiltration

② **OSI® QUAD MAX® Window, Door And Siding Sealant**

- Unique multi-polymer formula specifically engineered for premium replacement window installations
- Permanently flexible, will not crack or split even in extreme temperatures
- Water-resistant, all-weather applications, sticks to wet surfaces, no water washout
- Excellent UV resistance; will not crack or yellow

③ **Quality Edge No-Mar Coil Systems**

- Outperform PVC and Poly Coil finishes in ASTM physical test performance
- Features a finish with 8 mils of paint; that's twice the amount of paint used by most trim coil manufacturers
- Scratch resistant, stain inhibitors, better UV protection and harsh-climate coating
- Color selection - available in 30 unique color choices

④ **Concrobium Mold Control Spray**

- Innovative, market-leading product that effectively eliminates existing mold, prevents mold re-growth and eliminates musty odors with no harmful chemicals
- Effectively eliminates and prevents mold with no bleach, ammonia or VOCs
- Works as it dries by crushing the mold spores at the roots, leaving behind an invisible antimicrobial barrier to prevent future mold growth



WoodStar™



- WoodStar double-hung windows meet ENERGY STAR® requirements with a U-value of 0.27.
- Both frame and sash are cured with a water-repellent preservative that protects the window from mold, mildew, warping and splitting.
- Exterior and interior finish options include five maintenance-free aluminum cladding colors, plus an option for a high-quality, white interior paint finish.
- Full weatherstripping around both sash to prevent air infiltration and eliminate drafts.
- Superb architectural details include WoodStar's refined 45° glazing bead; clean, overlapping grids; and elegant recessed hardware.
- Clean your WoodStar windows in a snap: both the top and bottom sash tilt in for easy cleaning.

WoodStar Premium Glass

WoodStar double-hung windows come standard with our Premium glass, which incorporates two panes of glass, high-performance double Low-E coatings, Endur® stainless steel spacer system, and argon gas. This glass system meets the most stringent ENERGY STAR requirements so they will significantly enhance the comfort in your home and help save you money on your home energy costs.



The best components for the best performance.

QUALITY PONDEROSA PINE

- Ponderosa Pine is naturally resistant to rot and degradation over more typical pine species.
- Wood components are treated with a special preservative that inhibits rot and mildew, similar to high-quality deck sealant systems, which penetrates approximately 1/8" deep.
- Parts are submersed in the wood treatment for an average of 120 seconds, then air dried prior to fabrication.



Strong and straight grained Ponderosa pine offers exceptional beauty and strength

ALUMINUM CLADDING

- Extruded 0.050" wall thickness of the frame provides strength and excellent aesthetics.
- The electrostatic paint process ensures that paint adheres to all surfaces of the metal; the paint is baked on for an extremely durable finish designed to resist fading and stand the test of time.
- 0.024" wall thickness on the sash is perfect for the required bending and forming which allows the sash to be covered in all critical areas; this results in a high level of detail that provides eye-catching bevels and aesthetics expected of a high-end wood window.
- Special forming techniques provide a weather-tight seal.



Aluminum Clad Exterior shown in Forest Green (See options page for additional colors)

WEATHERSEALS

- An average of 300 inches of custom-designed Foam-Tite® compression bulb seals around the perimeter of the sash keep WoodStar windows airtight and allow the sash to open and close with ease.
- Custom-designed, full-perimeter beveled weatherseals on all sashes.
- Designed to work over a wide range of temperatures and weather conditions.
- The weatherseals utilize "kerf mounted" designs that allow for easy removal.
- The weatherseals feature special "stiffeners" that allow the weatherseals to maintain their length and shape, which is critical to insuring a weather-tight window.
- The stiffener is Polypropylene, a thermoplastic polymer that does not absorb water, and does not collect mold or otherwise deteriorate; it is also lightweight and flexible.
- This technology is similar to other seals you see on products you use everyday like cars, dishwashers, microwaves and refrigerators.



Foam-Tite compression bulb seals provide maximum protection from air and water

PVC JAMB LINER

- Rigid non-compression Jamb Liner adds strength, stability and reduces air infiltration.
- Special beveled design allows sash to tilt easily.
- Balance covers improve the look of the window.



PVC Jamb Liner available in both White or Almond

Unique Features

- The entire WoodStar product offering and all grid configurations are ENERGY STAR® certified.
- WoodStar sash tilts are built into the sash, unlike most wood windows which are built into the jambs; this eliminates an increase in air flow through the unit over time.
- Our patented Pivot Bar System keeps the sash and frame perfectly aligned.
- Locking 1/2 screen option.
- Designed to fit every opening with adjustable sill extenders included; windows are made in 1/4 inch increments.



WoodStar Performance Specs

ENERGY STAR® Qualified in All 50 States

01040980 Z-01 01 04/26/2017

NFRC
National Fenestration Rating Council®
CERTIFIED

H11-280 - 1
WoodStar
DOUBLE LOW-E RS-ARGON
FILLED DOUBLE GL
ALUM CLAD WOOD DOUBLE HUNG
H11-M-26-00376-00002

ENERGY PERFORMANCE RATINGS	
U-Factor (U.S./I-P)	Solar Heat Gain Coefficient
0.27	0.24

ADDITIONAL PERFORMANCE RATINGS	
Visible Transmittance	Air Leakage (U.S./I-P)
0.43	≤0.3

Manufacturer stipulates that these ratings conform to applicable NFRC procedures for determining whole product performance. NFRC ratings are determined for a fixed set of environmental conditions and a specific product size. NFRC does not recommend any product and does not warrant the suitability of any product for any specific use. Consult manufacturer's literature for other product performance information. www.nfrc.org

NFRC values above are for a WoodStar double-hung window with grids. NFRC rating may vary depending on operating style, options, and window size.

WOODSTAR Window (no grids)	U Factor	SHGC	VT
Double Hung	0.27	0.26	0.49
Picture	0.25	0.27	0.51
Casement	0.26	0.22	0.38
Awning	0.26	0.22	0.38

Why Do Windows Leak Air?

Poorly designed windows don't have the built-in airlocks, weather stripping, and barriers necessary to keep air from forcing its way in. Without these design features, air will push between the sash meeting rails and around the sash perimeter where it meets the frame and sill. We load our windows with weather barriers that go far beyond the industry standard and other manufacturers' window designs.

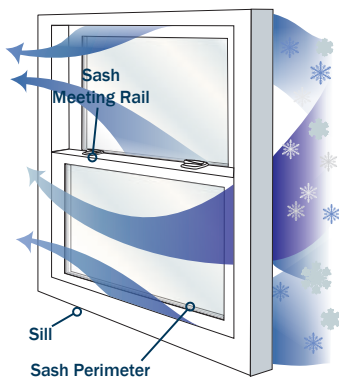

The lower the CFM Rating...

- the less outside air will leak into your home;
- the more comfortable your home will be with fewer drafts;
- the less your furnace will run & the more money you'll SAVE; and
- the smaller your carbon footprint will be.

INDUSTRY STANDARD*

.30 CFM

of air leakage per minute



2.25 gallons of air per minute



24 soda cans of air per minute
(288 oz/min)

Traditional Wood Residential Double-Hung Windows (includes major brands)

.23 CFM

of air leakage per minute
Industry Average Range from 0.12 CFM to 0.30 CFM**



1.725 gallons of air per minute



18.4 soda cans of air per minute
(220.8 oz/min)

WOODSTAR™

Premium Double-Hung Wood Windows

.17 CFM

of air leakage per minute
Industry Average Range from 0.11 CFM to 0.30 CFM**



1.125 gallons of air per minute



12 soda cans of air per minute
(144 oz/min)

*INDUSTRY STANDARD: AAMA® (American Architectural Manufacturers Association®) has set the Industry Standard for Maximum Allowable Air Infiltration at 0.30 CFM (Cubic feet per minute) during a 25 MPH wind. This is equal to 2.25 gallons or 24 soda can of air leaking through the window every minute!

**References valid as of May 15, 2017 based on our competitors' web sites and independent testing.

WoodStar™ Bay & Bow Windows



ENHANCE ANY ROOM WITH THE THREE-DIMENSIONAL EFFECT OF A BAY OR BOW WINDOW.

- Your choice of 3-lite to 6-lite configurations
- Your choice of 10°, 30°, or 45° projections
- Available with operating or fixed casements, double hungs or picture windows
- Available with WoodStar hardware and finish options (see opposite page)

STANDARD BAY/BOW WINDOW CONSTRUCTION FEATURES:

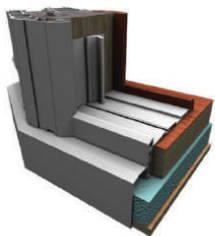

Weeped panning system provides a secondary measure against water infiltration. It is comprised of a sloped sill with hefty water chambers, offset low-profile exterior weep holes, baffling that provides bug shield and wind deflection, and dedicated interior evacuation holes.

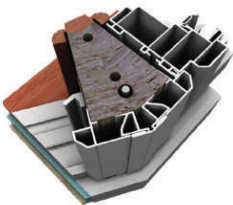

Unique Dual Mullion System constructed using a steel rod mullion surrounded by a solid LSL mullion. Creates a "clamped" connection of head, seat, & mullions that can never come apart. Evenly distributes load from the bottom of the window to the hanger system.

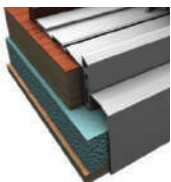

Insulated seat board is seamlessly integrated, constructed with 1" thick Dow polystyrene foam. The foam is fully laminated to 1/2" thick vinyl backed plywood then attached to the 1 1/4" plywood seat board. The 2 3/4" thick seat provides a insulating value greater than R7; R7+ exceeds current insert window R values with some to spare.



Premium, "best in class" cable support uses patented clamping system for cable anchoring. ATI tested to hold 1,500 lbs. per cable with ZERO slipping of the cables.



ADDITIONAL WOODSTAR WINDOW STYLES:

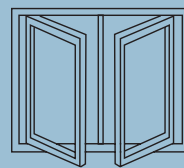

Casement



Picture

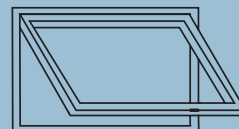

Awning

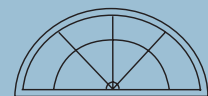

Shapes

Customization

EXTERIOR ALUMINUM CLADDING COLOR OPTIONS

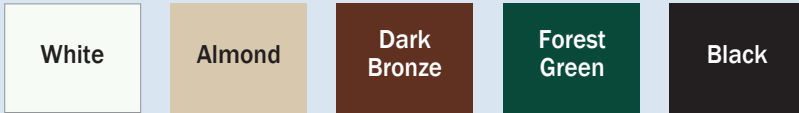

INTERIOR WOOD OPTIONS

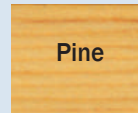

Warm, unfinished pine ready for you to stain or paint once installed.



Professionally prefinished for no mess or hassle post-installation. 10 year warranty.

HARDWARE

STANDARD FINISHES

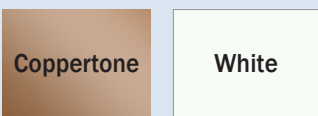

Double Hung Recessed Sash Lock



Casement Compact Folding Handle



Awning Handle



PREMIUM FINISHES

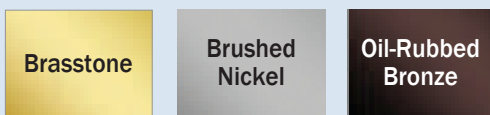

Standard Routed Sash Lift

Bottom Sash Lift Options (Double Hung)



Hook



Loop

GRIDS

GRIDS BETWEEN GLASS (GBG)

Sealed between the panes of glass, GBG are easy to clean.



INTERIOR SNAP-IN GRIDS

The curb appeal of divided lites with an easy to care for interior.



SIMULATED DIVIDED LITES (SDL)

The most authentic look of divided lites to complement traditional architecture



ADDITIONAL OPTIONS

- Obscured glazing
- Tempered glazing
- Jamb liner available in White or Almond

SCREEN OPTIONS

- Half or Full screens available
- Fiberglass Wire (standard)
- Aluminum Wire
- Premium VIEWS Screen (more at right)

VIEWS VIRTUALLY INVISIBLE SCREEN

Upgrade to VIEWS screens for a premium viewing experience. VIEWS screens are designed for 15% greater openness, providing 25% better airflow.

- 25% more optical clarity for a crisper, brighter view
- Improves light transmittance in Low-E glass windows
- GREENGUARD certified
- Ideal for windows where the focus is on the view

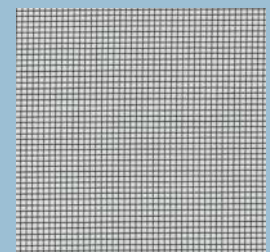

Due to printing limitations, finishes and colors shown are for representation only.



ANOTHER SATISFIED HOMEOWNER



WINDOW NATION

WINDOWS • SIDING • DOORS

1-866-44-NATION

www.WindowNation.com

MHIC #124358 VA#2705-109436A DC#4203 420313000103 PA#104611 NJ#13VH07997100

(866) 60-NATION • (866) 606-2846 • WindowNation.com

Servicing Ohio • Virginia • Maryland • Washington DC • Pennsylvania • Delaware • New Jersey

MHIC # 124358 • VA # 2705-109436A • DC # 420212000037 • DE # 2013601804 • PA # 104611 • NJ # 13VH07997100